

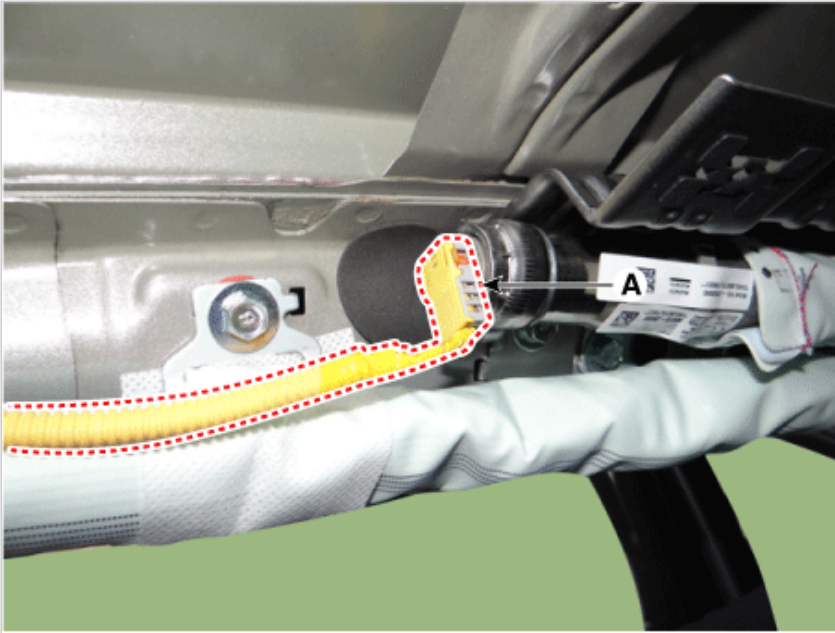

Removal

1. Disconnect the battery negative terminal, and wait for at least three minutes before beginning to work.
2. Remove the roof trim.
(Refer to Body (Interior and Exterior) - "Roof Trim Assembly")
3. Disconnect the connector (A) from the curtain airbag module.



4. Loosen the curtain airbag bolts and nuts and then remove the curtain airbag.

Tightening torque

Bolt : 7.7 - 11.7 N·m (0.79 - 1.2 kgf·m, 5.7 - 8.6 lb·ft)

Nut : 3.8 - 5.8 N·m (0.39 - 0.6 kgf·m, 2.8 - 4.3 lb·ft)

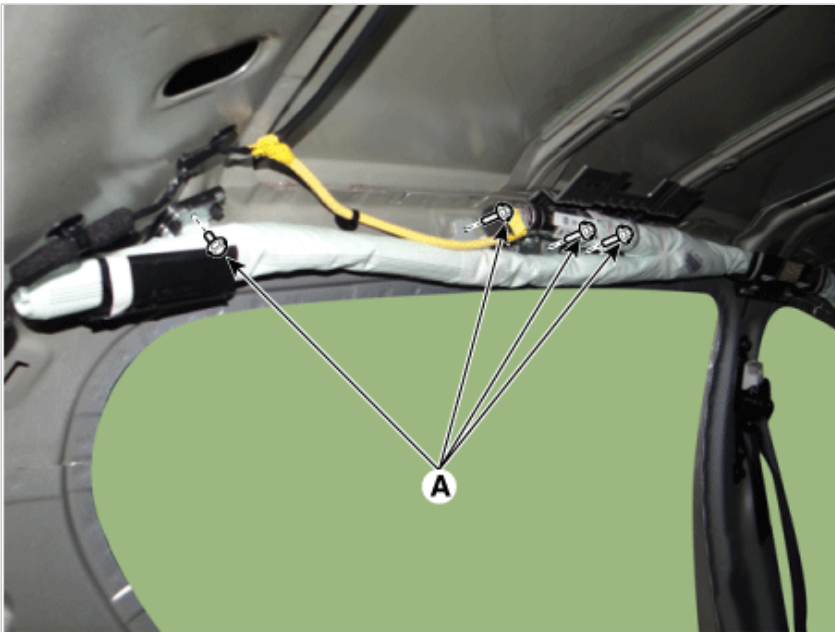

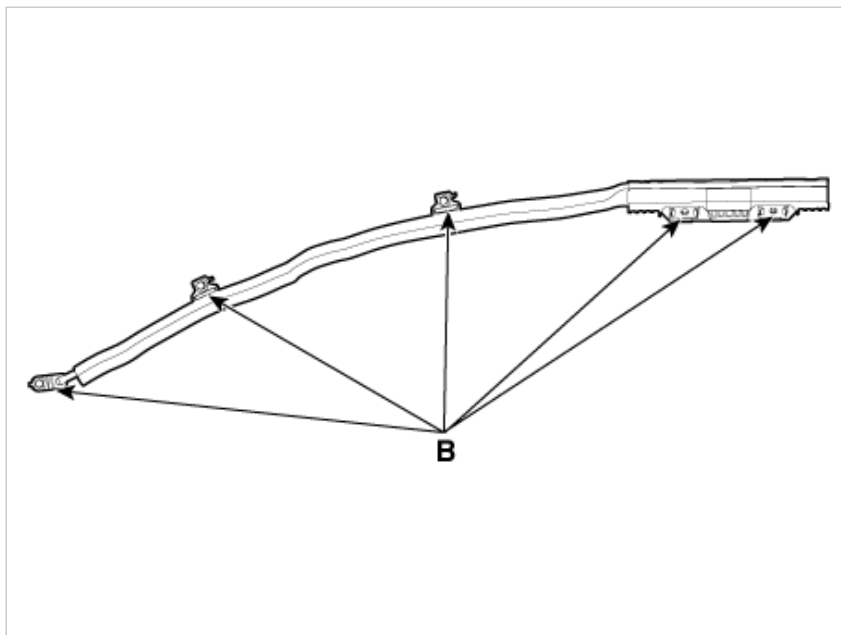
**CAUTION**

Never twist the airbag module when installing it. If the module is twisted, airbag module may operate abnormally.

Installation

1. Disconnect the battery negative terminal, and wait for at least three minutes before beginning to work.
2. Install in the reverse order of removal.
3. Reconnect the negative battery terminal.
4. After installing the curtain airbag (CAB), confirm proper system operation:
Switch "ON" the ignition. The SRS indicator light should turn on for about six seconds and then off.